



# pet proofing starter set

complete 10 piece set to keep your pet safe at home

## 1 door paw-tector

- Universal fit on most doors.
- Soft, flexible material.
- Keeps door open for cats to access litter box.



### INSTALLATION METHOD

- 1 Place Door Paw-tector on outer edge of door out of reach of pet. May also be placed on top edge of door, no less than 6 inches from outer edge.
- 2 Regularly check the Paw-tector for wear and replace if necessary.

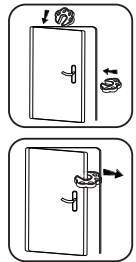

## 4 no-no cabinet latches

- Multi-functional. Works on most cabinets with even surfaces.
- Non-toxic, eco-friendly ABS material with mounting hardware for extra security.
- Spring action design offers press-n-release motion. Automatically self-locks.



### INSTALLATION METHOD

- 1 Pet Parent installation required. Clean and dry surface of cabinet thoroughly.
- 2 Using adhesive, position the catch approximately 1" from the inside top edge of the drawer or cabinet. Align the latch to engage with the catch. Once properly positioned, secure both the catch and latch into place with the screws provided.

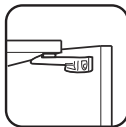
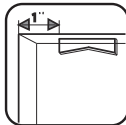

### OPERATION

To use, open drawer or cabinet slightly and press the latch down in order for it to clear the catch and fully open. When closing the drawer or cabinet, the latch will engage automatically. To disengage, press the latch completely down into the base until it 'clicks' enabling the drawer or cabinet to open/close freely.

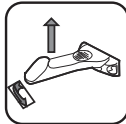

## 2 grip & glide cabinet locks

- Universal fit on side-by-side cabinets with knobs or D-shaped handles.
- Easy to operate double-button design.
- Adjusts to fit cabinets with knobs or handles up to 4.5" apart.



### INSTALLATION METHOD

- 1 Pet Parent installation required. Open lock by simultaneously pressing the side release buttons. Slide locking base off the locking arm.
- 2 Place locking arm around cabinet knobs or through handles.
- 3 Slide the locking base back onto the locking arm so the arrows align with the locks. Note: If the locks on the locking base are not properly aligned with the arrows on the locking arm, the locking latch will just slide off without having to depress the side gray buttons and will not be secure.

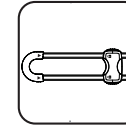
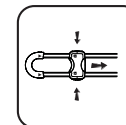

### OPERATION

Press the side release buttons simultaneously and slide off.

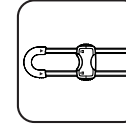

## 1 mischief minder strap lock

- Multi-functional. Works on cabinets, garbage cans, toilets and more.
- Use on doors to allow cats in but keep dogs out.
- Adjustable - cut to desired length.



### INSTALLATION METHOD

- 1 Pet Parent installation required. Clean and dry surface thoroughly.
- 2 Prior to placement, measure length of strap needed. Open the end of the strap with the MyPet logo by sliding the strap out from the latch housing. On the back of the strap use a flat headed screwdriver to pry open the back of the adjustable end. Cut to desired length. Reinsert the strap and snap cover shut insert strap back into the latch housing.
- 3 Remove paper from VHB® adhesive\* and press firmly into place. For best results, allow adhesive to set for 24 hours prior to use.

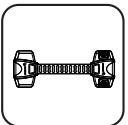

### OPERATION

To open, slide double-buttons inward. To lock, secure latch back into the latch housing until you hear it click into place.

### REMOVAL TIP

Easily remove product by applying heat (hairdryer) for about one minute. Gently pull product from surface.

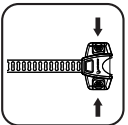

## 1 paws-off swivel cabinet latch

- Ideal for cabinets without handles or pulls.
- Non-toxic, eco-friendly ABS material with professional strength VHB® adhesive\*.
- Press-and-lift access, easy for Pet Parent, but not for furry paws.



### INSTALLATION METHOD

- 1 Clean and dry surface of cabinet thoroughly.
- 2 Remove adhesive backing and press Cabinet Latch in place. For best results, allow adhesive to set for 24 hours prior to use.

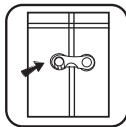

### OPERATION

To open latch, press center spring-release and swing up. To close, simply swing latch down and click in place.

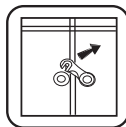

### REMOVAL TIP

Easily remove product by applying heat (hairdryer) for about one minute. Gently pull product away from surface.

## 10' ruff & tuff cord protector

- Universal fit. Cut to desired length.
- Durable material keeps cords protected.
- Easy to install, simply wrap around cord.



### INSTALLATION METHOD

- 1 Prior to placement, measure length of cord protector needed and cut to size.
- 2 Insert cord into protector using pre-cut opening.
- 3 Regularly check the cord protector for wear and replace if needed.

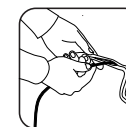

**CAUTION:** These products will not necessarily prevent all accidents and are only a deterrent. They are not a substitute for proper adult supervision. Stop using when pet can defeat them. Regularly check for wear and correct positioning. DO NOT use product if damaged or broken. FOR INDOOR HOME USE ONLY.

**WARNING:** Adult installation required. Do not use these products to guard against toxic and dangerous substances or objects. These dangerous items should always be kept "high-up" or placed in an area completely inaccessible to the pet. These products are not toys. DO NOT allow pets to play with them. Any damage to the property during installation or removal of this product is the sole responsibility of the end user.

**PRECAUCIÓN:** Estos productos no necesariamente evitarán todos los accidentes y solo son una medida disuasoria. No hay un sustituto de la adecuada supervisión por adultos. Deja de usar cuando la mascota puede derrotarlos. Revise regularmente por uso y posición correcta. NO use el producto si está dañado o quebrado. SOLO PARA USO EN EL INTERIOR DE LA CASA.

**ADVERTENCIA:** Se necesita que la instalación la haga un adulto. No use estos productos como protección contra sustancias y objetos tóxicos y peligrosos. Estos artículos peligrosos siempre se deben mantener "a gran altura" o colocarse en un área completamente inaccesible al mascota. Estos productos no son juguetes. NO permita que las mascotas jueguen con ellos. Cualquier daño ocasionado a la propiedad durante la instalación de este producto es la exclusiva responsabilidad del usuario final.

**MISE EN GARDE:** Ce produit ne préviendra pas nécessairement tous les accidents et n'aura qu'un effet dissuasif. Ces produits ne remplacent pas la surveillance appropriée par un adulte. Cessez de l'utiliser quand l'animal peut les vaincre. Vérifiez régulièrement l'usure et le positionnement correct. N'utilisez PAS le produit s'il est endommagé ou cassé. POUR USAGE DOMESTIQUE INTÉRIEUR SEULEMENT.

**ADVERTISSEMENT:** Installation par un adulte requise. N'utilisez pas ces produits pour vous protéger contre les substances ou objets toxiques et dangereux. Ces objets dangereux doivent toujours être conservés « en hauteur » ou placés dans un endroit totalement inaccessible à l'animal. Ces produits ne sont pas des jouets. NE laissez PAS les animaux jouer avec eux. L'utilisateur final est entièrement responsable de tout dommage matériel causé durant l'installation ou le retrait de ce produit.

MADE IN CHINA



0 26107 07190 3

DISTRIBUTED IN THE USA BY:  
NORTH STATES INDUSTRIES, INC.  
5455 HIGHWAY 169 N.  
PLYMOUTH, MN 55442  
1.800.848.8421  
WWW.NORTHSTATESIND.COM/PET