



## *Yankee Flipper (YF)*

***Please read Important Information and Safety Instructions before operating***

***Charging: Follow steps; Disassemble #1 and #2, and Assemble #5***

***Disassemble for Easy Cleaning and Part Replacement***

1. Check the black activation switch, which is located on the base assembly, is in the "OFF" position.
2. Disengage the base of the feeder by first placing the base in the palm of your right hand with the black activation switch facing you, while firmly holding the lower section of the tube with your left hand. Insert fingers upward through perch ring spokes and grasp the base assembly (like a small ball) firmly with your fingers, placing your thumb against the right side of the black activation switch for leverage, and twist counter clockwise (viewed from the bottom) approximately ½". You will feel a distinct click and then lower the base which will separate from beneath the port.
3. Remove the four tube screws to release the tube from the port. The port and silo assembly may be disassembled for easy and thorough cleaning, by removing the three screws located inside the bottom of the port.
4. Remove the cap and bail wire assembly by sliding the cap up the bail wire. Gently pull each end of the bail wire out of the bail rod.
5. Remove the bail rod by laying the tube on a flat surface with the bail rod parallel to the table/floor. Apply pressure to the top of the tube until it becomes oval/oblong in shape to free one side of the bail rod. Reach inside the tube and shimmy the other end of the bail rod out of its hole.

***Assemble***

1. Install the bail rod inside the top of the tube by lining the bail rod up with both of the designated holes. Apply pressure to the outside of the tube at both ends of the bail rod until the tube locks into the groove at each end of the bail rod.
2. Replace the cap and bail wire assembly by inserting each end of the bail wire into the bail rod, making certain they are fully inserted before sliding the cap back into place on top of the tube.
3. Assemble the port and silo assembly, if you chose to disassemble for easy and thorough cleaning, by placing the silo assembly inside the port. Hold the silo assembly and port upside down and rotate the silo assembly until the three holes in the port line up with the three plastic posts on the silo assembly. Replace the three screws.
4. Install the tube by lining up the four holes in the tube with the four holes in the port and replace the tube screws. ***Do not overtighten the screws as this will cause the tube to crack, especially in hot weather.***
5. Install the base by placing it up inside the port and aligning any of the three arrows on the underside of the base assembly with the left hash mark on the side of the port, and turn clockwise (viewed from the bottom) until it clicks into place. The arrow on the base assembly should be aligned with the right hash mark on the port when properly installed.

***BASE (Motor Unit): Disassemble for Power Stick and Part Replacement***

***Note:*** Two changes were made to the Power Stick in 2008. The switch no longer has a vertical black pin which had a tendency to indent or puncture the black switch bumper. This change will not affect the performance of the new Power Stick and will work in your unit. The input jack on top of the Power Stick, for charging purposes, was also changed. Please contact Droll Yankees if your original AC/DC Adapter (charger) will not fit into the input jack on top of your new Power Stick or if the black switch bumper on your base assembly has become worn, indented or punctured. The black switch bumper can only be viewed for inspection by removing the Power Stick from the base assembly.

**Please visit:** <http://drollyankees.com/video/yankee-flipper-power-stick-replacement/> to watch a short video on replacing your Power Stick.

1. Check the black activation switch, which is located on the base assembly, is in the "OFF" position.
2. Use a 7/16" or 11mm socket, nut driver, or wrench to remove the nut at the bottom of the base, below the perch ring.

3. Remove lock washer, hub (grooves engage perch ring), perch ring, and green or clear plastic friction disc.
4. Remove the Power Stick from the base assembly by pulling the Power Stick upward.

**Note:** *The black switch bumper is glued to the base assembly at the factory. If the switch bumper separates from the base assembly, it will be necessary to glue it back into place. Remove any residue remaining and apply a small amount of Super Glue®, Krazy Glue®, etc. to the smaller slot in the base assembly and slide the switch bumper in place. The top of the switch bumper should be flush with the top rim of the base assembly. Please wait a few minutes for the glue to dry before installing the Power Stick.*

### **BASE (Motor Unit): Assemble**

1. Hold the base assembly upright and position the spring vertically inside the center cavity of the base assembly.
2. Align the black switch bumper, located on the top rim of the base assembly, with the switch on the Power Stick and insert into the base assembly.
3. Flip the base assembly and the Power Stick upside down in your lap with the drive shaft on the Power Stick pointing upward. Rotate the Power Stick until the flat side on the drive shaft, just below the threads, is facing to your right.
4. Depress the spring by pushing down the lip on the base assembly and hold. This will allow additional space for installation of the remaining parts on the drive shaft.
5. Install, in this order: **Green or clear plastic friction disc**; smooth side facing the base assembly. **Perch ring**; large diameter ring facing downward, placing the perch ring spokes in a plus sign (+) position. **Hub**; install with the flat side in the center of the hub facing to your right. **Note:** *The flat side in center of hub will align with the flat side on the drive shaft when hub is depressed and will lock into place. Installed properly, the 4 perch ring spokes will align with the 4 grooves in the hub. Keep hub depressed to install the lock washer and nut.* **Lock washer**; required to keep nut from loosening. **Nut**; first tighten by hand and then use a 7/16" or 11mm socket, nut driver, or wrench to finish tightening. Compress lock washer + 1/8 turn or torque to 10-15 in/lbs. End of drive shaft should be flush with the bottom of the nut. **Do not over tighten nut.**

### **Feeder Placement**

Hang the feeder far enough away from any deck rail, pole, tree, etc. so that the squirrel must place all of its body weight on the perch ring. The recommended minimum is 14", but a greater distance may be preferable since the mechanism is based on weight. A squirrel that is able to lean across to the feeder by placing only part of its weight on the perch ring may avoid activating the perch ring.

Red squirrels and chipmunks may not be heavy enough to activate the perch ring, but placing the feeder so that they have to jump to it will significantly increase your chances of deterring them.

**Cleaning:** *Please for the sake of the birds, keep your feeders clean!* Dirty feeders can harm the birds. Clean feeder, after base removal, with a mild dish detergent using a soft brush, sponge or cloth, and rinse thoroughly with water for simple cleaning.

**Sanitizing:** Rinse feeder with a 50/50 solution of white vinegar and water. Do not soak as this will affect the finish on the metal components. Rinse thoroughly with water. **Dry completely before filling with seed.**

### **Important Information**

- When turning the black activation switch to the "ON" or "OFF" position do not come in contact with the perch ring. If one of the four perch ring spokes is obstructing access to the activation switch, the perch ring can be rotated by hand with the switch in the "OFF" position. Tap the perch ring with your finger if one of the four perch ring spokes is obstructing access to the activation switch when in the "ON" position.
- The Power Stick, which contains the batteries, motor and gearbox, is shipped with a slight charge in the batteries for testing purposes and requires charging before use.
- Insert the AC/DC Adapter (charger) output plug into the input jack located at the top of the Power Stick. Never loop cord through the perch ring.
- Charge the batteries in the Power Stick for a minimum of 14 hours, but not more than 24 hours. Repeated undercharging can result in a battery condition known as "memory" to occur. Overcharging can damage the batteries, resulting in shortened battery life.
- Recharge the batteries only when they fail to produce sufficient power to spin the perch ring and remove the squirrels. Place the base in a location that is out of reach of children and where it will not be dropped or knocked over. It should be charged indoors and charged at room temperature.
- Unplug the AC/DC Adapter (charger) from the electrical outlet and store in a safe place when charging is complete.
- Hang your feeder on a rigid hook and secure the feeder from falls.

## ***Important Safety Instructions***

- Read and understand all labels and information on this product before operating.
- This feeder has motorized moving parts. Common sense should be exercised. Failure to heed any of the warnings contained herein could result in serious injury.
- Turn the black activation switch to the “OFF” position before transporting, removing the base, charging, filling or cleaning.
- Turn black activation switch “OFF” if freezing rain is in the forecast. Use caution if icicles have formed on the perch ring.
- Do not come into contact with the perch ring when turning feeder “ON” or “OFF”.
- Keep feeder out of reach of children and pets.
- Do not immerse the Base, Power Stick or AC/DC Adapter (charger) in water.
- Do not open the Power Stick for any reason.
  - If the Power Stick is cracked, damaged or if battery leakage is suspected, discontinue use immediately.
  - Parts contained in the Power Stick are not replaceable.
  - ***All warranties are void if the Power Stick is opened or tampered with.***
- The Power Stick contains Nickel-Cadmium batteries. Do not incinerate. Dispose of properly in accordance with local laws.
- Do not place AC/DC Adapter (charger) or feeder near heat or fire.
- Charge only with Droll Yankees AC/DC Adapter (charger).
  - Use of incorrect charger may create a risk of fire or cause the batteries to burst.
  - Do not use charger in damp or wet conditions.
  - Do not use the charger if it has been dropped or damaged in any way.
  - Do not disassemble the charger.
  - The charger is designed to operate on standard household electrical power of 120 volts, 60HZ only. Do not attempt to use on any other voltage.
  - Do not carry the charger by the cord or yank the cord to remove the charger from the outlet.
  - Keep the cord away from moving parts, heat, oil or sharp edges. Inspect the charger cord for damage before every use. Discontinue use of damaged chargers immediately.

## ***Troubleshooting***

- The perch ring fails to activate
  - Make sure the activation switch is in the “ON” position.
  - Check the black switch bumper on the rim of the base assembly. Has the switch bumper become worn, indented, punctured or is missing?
- The feeder needs to be recharged frequently
  - Raccoons, deer, bears or other large animals may be attempting to eat at the feeder. You may need to bring the feeder in at night until they go elsewhere for food.
  - If you have many squirrels in your yard, you may need to recharge the feeder more frequently at first. However, they should quickly give up and move on to food sources that require less effort.
  - Frequent unnecessary recharging or under charging can result in a condition known as “memory” to occur. It is possible to correct this condition by carefully following the charging instructions, but it may take multiple charge/discharge cycles to bring the batteries back to capacity.
- The perch ring continues to spin once activated
  - Base disassembled for part replacement without placing the spring back into center cavity of the base assembly.
  - Black activation switch on the base assembly turns completely around and does not lock into the on/off positions.
  - Remove the Power Stick from the base assembly and manually check the activation switch on the Power Stick to see if it is possibly sticking.
- Unable to remove the hub
  - Hold the base upside down while firmly holding the perch ring and use a hammer to tap the end of the drive shaft of the Power Stick. This will release the hub if it has corroded over the years due to consistent wet conditions.

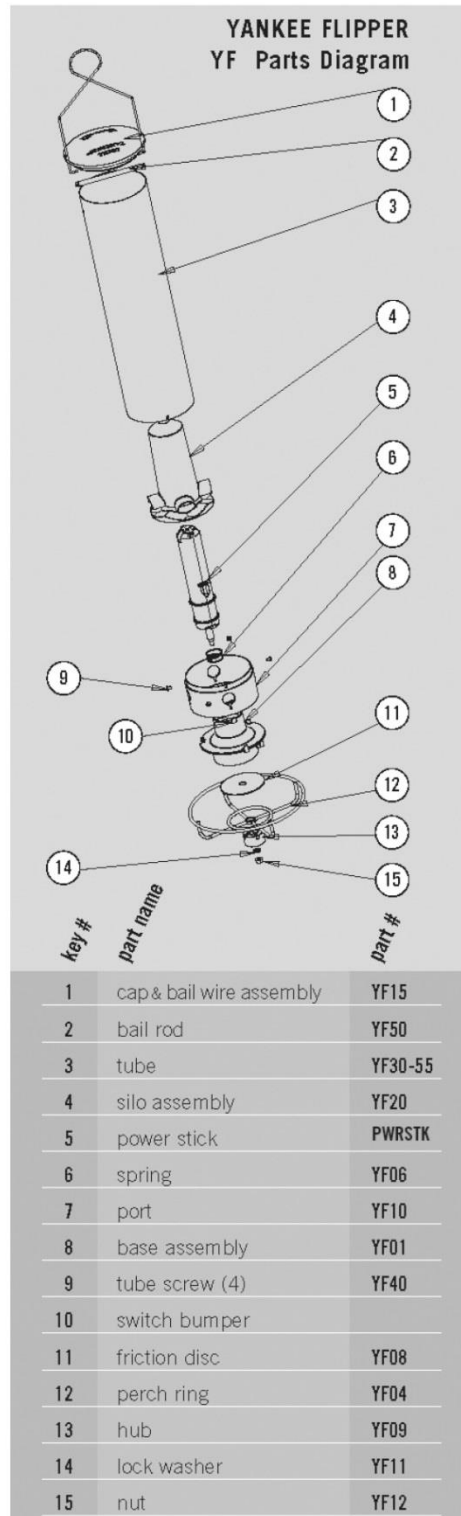

Droll Yankees Inc. • [www.drollyankees.com](http://www.drollyankees.com)  
 Customer Service: [drollbird@drollyankees.com](mailto:drollbird@drollyankees.com)  
 (860) 779-8980 or (800) 352-9164