



## Installation in:

Wooden Doors  
Plastic Doors  
Plasterboard Walls

## Tools you will need:

Blu Tack  
Crosshead Screwdriver  
Drill  
Jigsaw  
Sharpened Pencil  
Spirit Level  
Ruler

DIY installation may involve the use of power tools or cut glass. Safety equipment (gloves, eye protection, etc.) should be used and if in doubt consult a professional to carry out the installation.

## Suitable Door Types

Instructions are provided for installation in all door types, including wooden, plastic, glass and metal. Before installing in a door with unknown construction, please check for a metal plate in case a larger hole is required, as described in the metal door installation section.

If you can only be sure of the construction of the door by drilling a hole in it, make a trial hole anywhere covered by the proposed hole for the SureFlap Microchip Pet Door.

*Note:* a simple test for the presence of a steel plate in the door is with a magnet. If the magnet is attracted to the door then there is a steel plate within, and you must follow the instructions for mounting in a metal door. However, even if a magnet is not attracted to the door, still check for the presence of other metals, such as aluminium, which require the same mounting conditions.

## Pet Door Positioning

The ideal height of the SureFlap Microchip Pet Door is such that the base of the tunnel is the same height above the ground as your pet's stomach. In practice however, mounting is normally dictated by features in the door into which the unit will be installed. In these circumstances, it is usual to mount the pet door as low as possible.

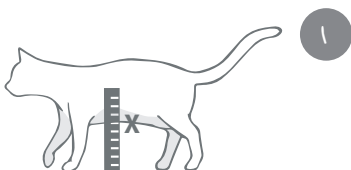

Measure the height of your pet's stomach from the floor when your pet is standing. This height is the level at which the bottom of the hole should be cut through the door. Make a mark on the door at this height. Note: If there is a large drop on the outside of the house you will need to place a step outside for your pet to access the tunnel.



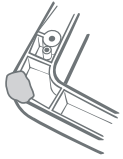

- 2 Place the external frame face down. Attach a ball of Blu Tack (or similar adhesive putty) in each of the four corners. This should allow you to stick the frame to most doors.

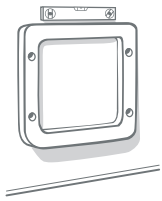

- 3 Choose the position on the door at which you want to mount the pet door and stick the frame to the door. To ensure that it is level we recommend you use a spirit level.

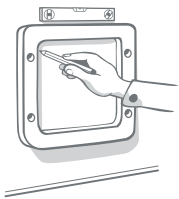

- 4 Run a sharpened pencil or pen around the inside edge of the frame where it would touch the door and also mark the four screw holes. You need to make a legible line as this will be used for cutting against.

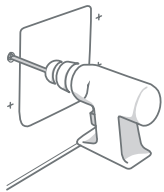

- 5 Remove the frame from the door and check you have a solid line and dots where the screw holes are. Using a drill with a 6mm (0.25") diameter bit, drill the holes for the screws. It is vital these holes are drilled straight to ensure the two halves of the pet door connect properly.

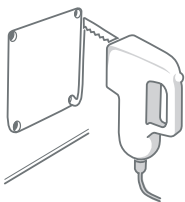

- 6 Before you cut out the hole for the tunnel, drill holes in all the corners large enough to allow your jigsaw blade through. Cut out the tunnel hole with an electric jigsaw. Ensure you cut 2mm (0.078") outside the line you have marked for the hole to allow enough clearance for the tunnel. Make sure that your jigsaw is sitting flat on the door at all times while cutting.



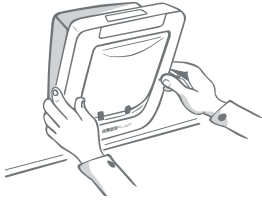

7

Clean off any loose debris, dust and dirt from the door before you install the SureFlap Microchip Pet Door.

8

Mount the pet door in the hole with the main assembly (battery covers and LCD screen) inside the house.

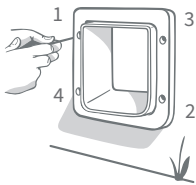

9

Mount the external frame on the outside of the house. Depending on the thickness of the door, the tunnel will protrude through the frame by differing amounts. Under no circumstances should you cut or drill through the tunnel as this contains the microchip reader and will prevent the unit from working properly. Three different lengths of screw have been provided for your use. Choose the correct screw length to suit the thickness of your door. If you are not sure, use the smallest first, if this is too short use the next size up. Take care not to use a longer screw than needed, as this may damage the main assembly front face. Screw the external frame to the main assembly.

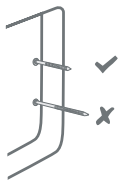

10

When the pet door has been mounted correctly, place the screw caps over the screw holes on the external frame. Align the screw caps with the slot pointing outwards and push firmly into place. To remove the screw caps slide a flat blade screwdriver into the side slot and lever the cap out of the hole.

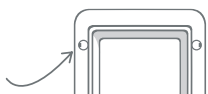
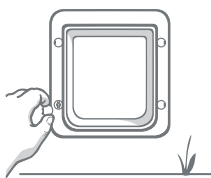

## Installation in Metal Doors

The presence of a metal plate in a door can influence the performance of the SureFlap Microchip Pet Door, reducing the range of the microchip reader. This includes the following:

- Metal skin doors
- Security doors
- Metal garage doors
- UPVC coated metal doors

For most situations you will not notice anything, as the read range will still be sufficient for the majority of microchips and collar tags. However, if you experience intermittent operation or failure to open for your pet, first check for the presence of a metal plate in the door.

*Note:* UPVC coated metal doors often look the same as standard UPVC doors and you may need to look carefully where the panel has been cut. If a metal plate or thin metal foil is confirmed, follow the instructions below for improved read range.

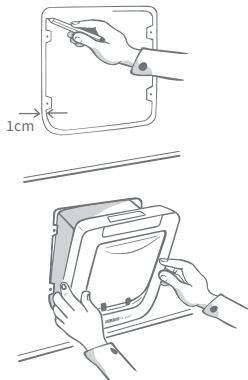

If there is metal present you will need to cut a larger hole in your door, leaving a gap of 2-3cm (1-1.2") between the tunnel of the pet door and the metal in your door. To begin with, trace around the outer edge of the back frame as a size guide. Now mark your cutting line 1cm (0.3") inside the line you have traced around the back frame, leaving the screw holes in place. Cut this hole and reinstall the pet door.

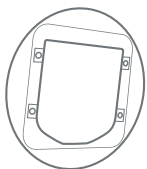

If you still experience intermittent operation you will need to increase the size of the hole again, in this case you will require the pet door mounting adaptor. For details of where to purchase this adaptor see our website [www.sureflap.com](http://www.sureflap.com).

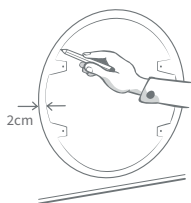

First trace around the circumference of the mounting adaptor as a guide. Now mark a circle approximately 2cm (0.078") inside the line from the mounting adaptor, again leaving the indentations for the screw holes. Cut this hole and then reinstall the pet door again. This will extend the read range further and should resolve any issues with mounting in a metal door.





## Installation in:

Glass Doors  
Windows

## Tools you will need:

All Weather Sealant  
Crosshead Screwdriver  
Spirit Level

DIY installation may involve the use of power tools or cut glass. Safety equipment (gloves, eye protection, etc.) should be used and if in doubt consult a professional to carry out the installation.

The SureFlap Microchip Pet Door is ideal for mounting in single or double glazed windows. If you need to have a hole cut in a window, please ask a qualified glazier to do it, as cutting glass is a skilled job. A circular hole with a diameter of 300mm (11.8") is the ideal size. A pet door mounting adaptor is available to complete an installation in glass, and is suitable for covering holes from 294mm (11.6") to 320mm (12.6") in diameter.

For details of where to purchase this adaptor see our website at [www.sureflap.com](http://www.sureflap.com).

If you have a double glazed window you will need to get a replacement unit manufactured with the hole cut in it. If possible you should request the use of a non-metallic spacer bar. Once your glass has been cut and installed in the door or window you are ready to complete the installation.

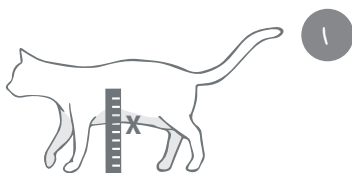

1 Measure the height of your pet's stomach from the floor when your pet is standing. This height is the level at which the bottom of the hole should be cut through the wall. Make a mark on the wall at this height. Note: If there is a large drop on the outside of the house you will need to place a step outside for your pet to access the tunnel.

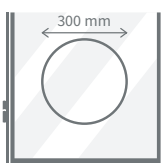

2 A circular hole 300mm (11.8") in diameter is required to accommodate the tunnel.



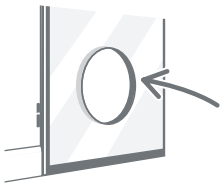

3 If installing the SureFlap Microchip Pet Door in a double glazed panel your glazier should seal between the panels around the circular hole to avoid moisture collecting inside. Do not use metal in any such seal.

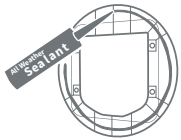

4 We recommend running a bead of 'All Weather Sealant' around the edge of the mounting adaptor for both sides of the glass. The sealant will help secure the pet door in place after installation, particularly with larger hole sizes, and also help prevent moisture getting in from outside. This type of sealant can be purchased from a glazing company and most DIY stores.

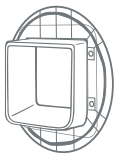

5 Slide one of the mounting adaptor rings over the main assembly.



6 From inside of the house, slide the tunnel of the main assembly through the hole in the glass.

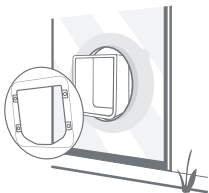

7 From outside of the house, mount the second part of the mounting adaptor and then the external frame.

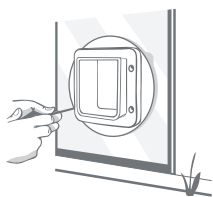

8 Screw the two halves together. If mounting in a single pane use the shortest of the three pairs of screws. A double glazed panel may require the mid-sized screw, depending on its thickness. Check the assembly is centred with the circular hole before fully tightening the screws.

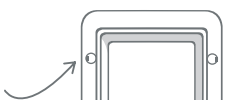

9 Align the white screw caps with the slot pointing outwards and then push firmly into place.

10 From inside the house you will now see your pet's stylish new entrance.





## Installation in:

Walls

## Tools you will need:

All Weather Tape

All Weather Sealant

Blu Tack

Masonry Drill

Masking Tape

Sharpened Pencil

Spirit Level

Ruler

DIY installation may involve the use of power tools or cut glass. Safety equipment (gloves, eye protection, etc.) should be used and if in doubt consult a professional to carry out the installation.

When you are making holes through the wall of your property please consult a qualified builder.

*Note:* When planning the installation of a SureFlap Microchip Pet Door in a wall, remember that you may need to remove the pet door if you move house or upgrade to a newer model. With this in mind, do not glue the main assembly of the unit to the wall, as removing it will be difficult and could damage the surface of your wall.

For installation of the SureFlap Microchip Pet Door in a wall, we recommend that you use Pet Door Tunnel Extenders, which can be purchased through [www.sureflap.com](http://www.sureflap.com).

Choose your mounting position on the wall ensuring that your pet will have easy access through the pet door in both directions.

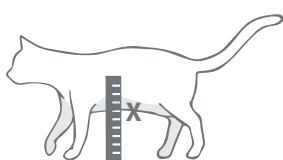

1

Measure the height of your pet's stomach from the floor when your pet is standing. This height is the level at which the bottom of the hole should be cut through the wall. Make a mark on the wall at this height. Note: If there is a large drop on the outside of the house you will need to place a step outside for your pet to access the tunnel.

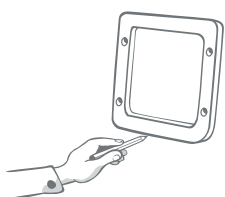

2

Take the external frame as you will need to use this as a template to mark the hole in the wall. Firstly, make a small pencil mark at the bottom of the external frame in the centre.



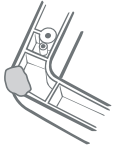

3 Put a piece of Blu Tack or similar low tack putty on the four corners of the frame.

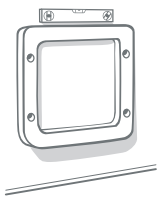

4 Stick the external frame to the wall on the inside of the house, lining up the pencil mark and bottom of the frame with the mark you have made on the wall. Use a spirit level to ensure that the frame is level.

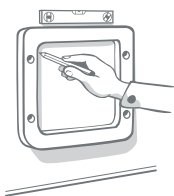

5 Using a pen or pencil draw around the inside of the frame on the wall so you have a clearly visible cutting line. You can now remove the frame from the wall.

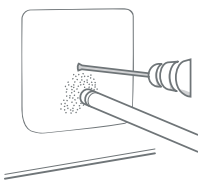

6 Before you start to cut the hole through the wall, remove the pet door from the area to minimise the amount of dust and debris the product is subjected to.

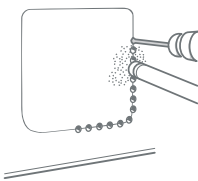

7 We do not recommend that you cut through the inside and the outside surface of the wall in one go. Cut the hole on the inside of the house first and then move outside to cut the hole there. You may want to drill one hole straight through the wall in the centre of the tunnel as a guide.

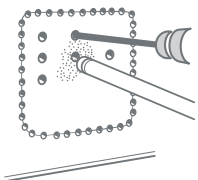

8 Whether you are cutting through brick, wood, tiles or plaster, you should drill some pilot holes first around the perimeter of the line you have drawn. These holes should go slightly over the line by no more than 1 or 2mm (0.04 - 0.07"). Then remove all of the material in the centre using the most suitable tools for the material you are cutting.

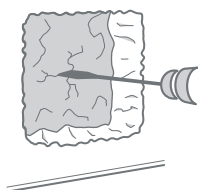



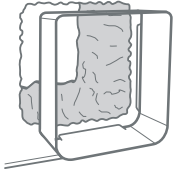

9

It is important not to make the hole too large or you will not be able to screw the pet door to the wall.

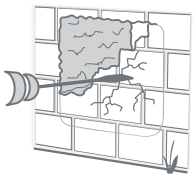

10

Once you have made the hole on the inside of the house, you can move to cutting the hole on the outside of the house. Remember to make the hole on the outside of the house slightly lower than the inside so that rain can run out of the tunnel. Clear away any dust and debris from inside the hole.

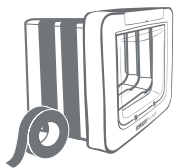

11

Fix the tunnel extenders together and to the end of the pet door tunnel using an All-Weather adhesive tape. Do not use glue in case you have to make adjustments or remove the pet door.

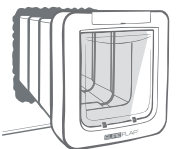

12

From the inside of the house, put the tunnel extenders and pet door into the hole through the wall until the pet door is flush against the wall. At this point you can tell whether the holes are large enough or need adjusting. If no adjustment is necessary you are at the point where you can make the holes for screwing the pet door to the wall.

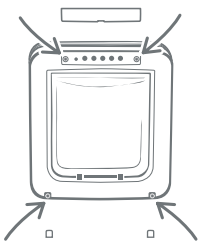

13

The screw holes for mounting the pet door to the wall are underneath the front panel. To remove the front panel, you need to remove the button cover and the two screw caps at the bottom of the pet door. Unscrew the four screws and remove the front panel.





- 14 There are four screw mounting positions for the pet door. Mark on the wall at the four positions using a pencil or pen. Do not drill through the hole as this will get debris and dirt in the locking mechanism of the pet door.

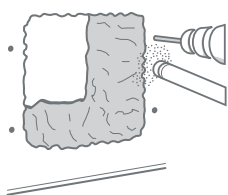

- 15 Remove the pet door and tunnel extenders from the hole in the wall and away from the area while you drill the four holes in the wall.

- 16 Replace the pet door and tunnel extenders in the hole and use any of the screws that came with the pet door to fix the product to the wall. We recommend screwing to the wall by hand so you do not over-tighten the screws.

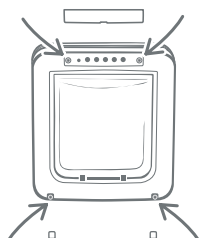

- 17 Replace the front panel using the four screws. Push in the screw caps and replace the button cover.

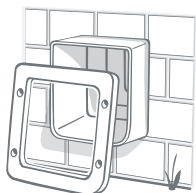

- 18 On the outside of the house you will have the tunnel extenders exiting the wall. Place the external frame over the extender and using a pencil or pen, mark the location for the four screws.



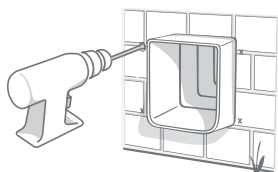

19

Remove the frame and drill the four holes for the screws.

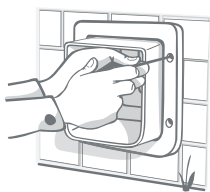

20

Replace the external frame and screw in position. Insert the screw caps.

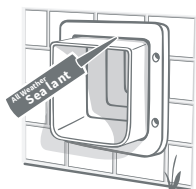
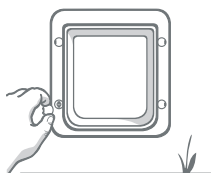

21

Use a silicone sealant around the joint between the tunnel extenders and the external frame and around the top and two side of the frame where it meets the wall.

